

## Block Disclosure Plan

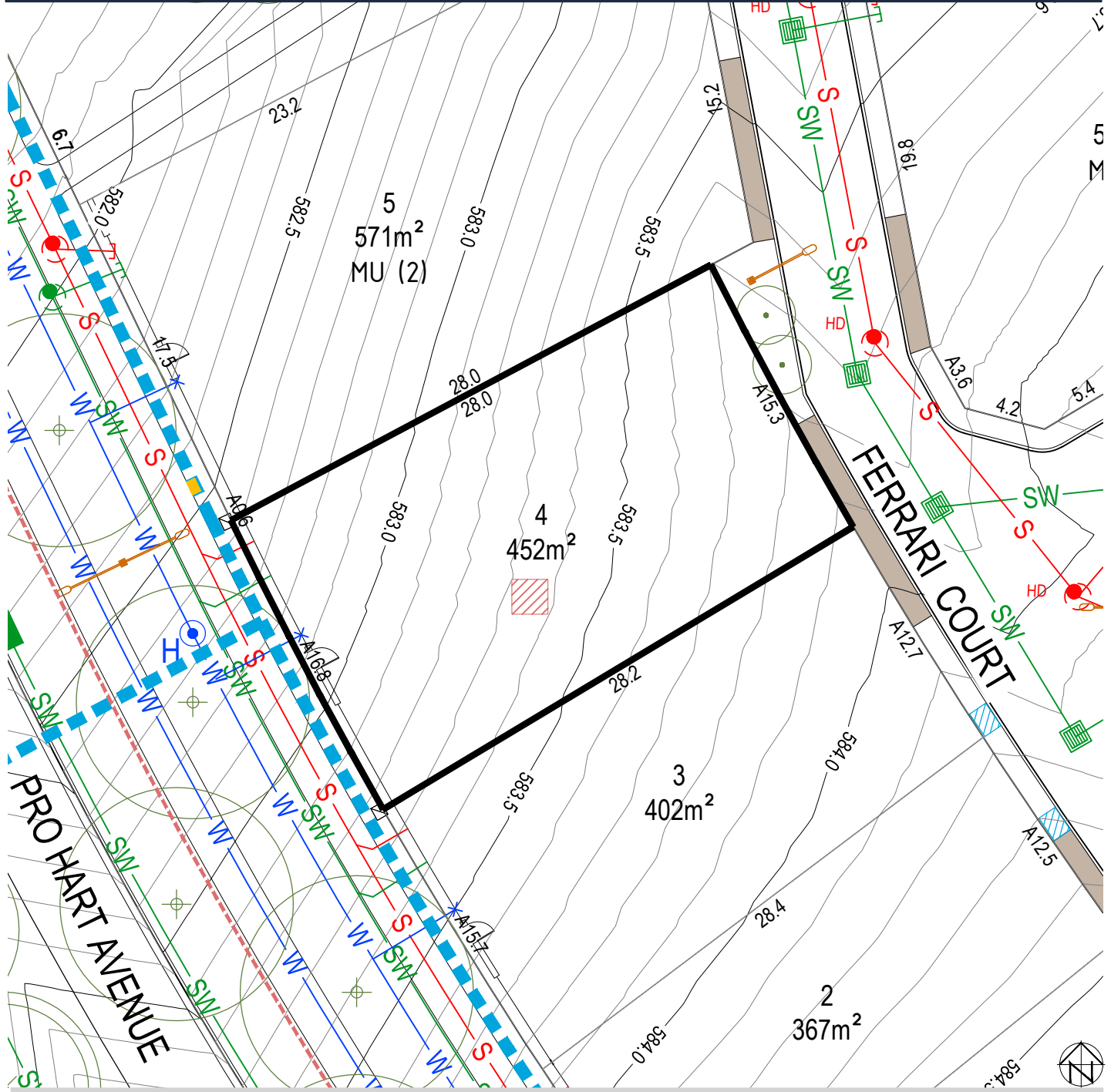

BLOCK LAYOUT - SCALE 1:300

ISSUE DATE: 05/09/2018

### LEGEND

|  |   |  |  |  |                                     |  |                                       |
|--|---|--|--|--|-------------------------------------|--|---------------------------------------|
|  | LOT BOUNDARY                            |  | SEWER MAIN / MANHOLE / TIE                       |  | SERVICES TRENCH                     |  | WASTE COLLECTION POINT                |
|  | EASEMENT                                |  | STORMWATER MAIN / SUMP / MANHOLE / TIE           |  | NBNC PIT                            |  | SUBSTATION                            |
|  | CONTOUR 0.5m INTERVAL                   |  | WATER MAIN / STOP VALVE / HYDRANT / TIE          |  | STREETLIGHT                         |  | STREET TREES                          |
|  | CONTOUR 0.1m INTERVAL                   |  | WATER MAIN (IRRIGATION)                          |  | ABOVE GROUND MINIPILLAR             |  | GARAGE OFFSET FROM REAR BOUNDARY      |
|  | RETAINING WALL                          |  | REINFORCED CONCRETE DRIVEWAY BY PURCHASER        |  | IN GROUND MINIPILLAR                |  | BLOCK SUBJECT TO MID-SIZED PROVISIONS |
|  | MANDATORY TWO(2) STOREYS                |  | REINFORCED CONCRETE DRIVEWAY BY CIVIL CONTRACTOR |  | FRONT FENCING AND GATE BY DEVELOPER |  |                                       |
|  | SEWER MAINTENANCE ACCESS ROUTE REQUIRED |  | POTENTIALLY NOISE AFFECTED BLOCK                 |  |                                     |  |                                       |

PLEASE NOTE: INFORMATION SHOWN IN THIS DRAWING IS FROM FINAL DESIGN AND IS SUBJECT TO CHANGE DURING CONSTRUCTION  
REFER ALSO TO PLANNING CONTROLS PLAN AND FENCING CONTROLS PLAN

Disclaimer: All care has been taken in the preparation of this material. No responsibility is taken by the vendor for any errors or omissions, and details may be subject to change. All road designs, contours, block sizes, block dimensions, easements, services, ties and trees are subject to change.